

Auto

Channel duct type 35

Geovent channel duct type 35 for the extraction of exhaust gases, welding fumes, etc. With up to 100 m of duct, the channel duct gives the user a large working area. There are no fixed extraction points, as the trolley can be moved to where it is needed. The channel duct can be equipped with a larger number of trolleys, depending on the project design.

The channel duct is optimally used in linear flow car inspections as well as in medium and large workshops.

User-friendly

The hose trolley type 35 is equipped with 8 easy-running nylon wheels, which provide effortless movement of the trolley. At the same time, heavy hoses on the floor are avoided.

The hose reel can be supplied with various accessories to make everyday life easier for the operator including remote controlled electric motors on the trolley, and compressed air nozzles for automatic exhaust decoupling.

Ease of installation

We have put great emphasis on making our channel duct and the accessories as easy to install as possible.

The new design incorporates several new features, to improve function and to reduce installation and service costs.

Specific benefits

- The system is easier to install, thus saving time.
- Everything can be mounted in the ceiling and finally the channel duct is lifted into place and fixed.
- It is easier to install on an angled ceiling, etc.
- The rubber lips are easily clicked in and fixed with barbs. No screwing required.
- It is easier to move the trolley as there is less friction in the lips and the trolley is lighter.
- EPDM lips and now also silicone lips are available. The silicone can withstand temperatures up to 180°C and has lower friction than EPDM.
- The end cap has an edge to make it easier to fix
- Duct connection from the side is possible
- Duct connection from the top available in 2 different versions
- Wires for stabilisation are used instead of rods, so they can be easily adapted to the desired length.



Channel duct type 35

Ordering table

Art. No.	Description
07-300	Channel duct type 35 extruded aluminium with EPDM rubber lips, max. 120°. Height: 288 mm. Width: 178 mm. Channel = 260 cm ² = ø180 duct. 7 kg pr. meter. Lengths of 3 and 6 meter. Price per meter.
07-300A	Channel duct type 35 extruded aluminium with Silicone rubber lips, max. 180°. Height: 288 mm. Width: 178 mm. Channel = 260 cm ² = ø180 duct. 7 kg pr. meter. Lengths of 3 and 6 meter. Price per meter.
07-322	Trolley type 35, powder coated steel. Complete with 8 smooth-running nylon wheels and ø150 mm NP connection. For air flows up to 1.200 m ³ /h.
07-323	Trolley type 35 for extraction arms ø160 mm. For air flows up to 1.200 m ³ /h.

Channel duct type 35

Technical Drawing, trolley

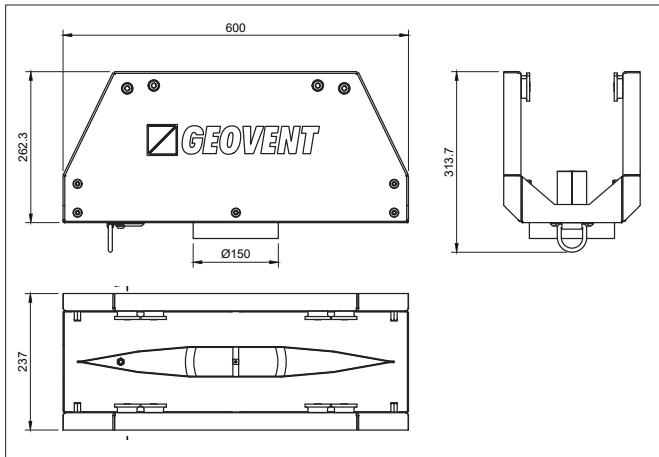

Cross section of trolley

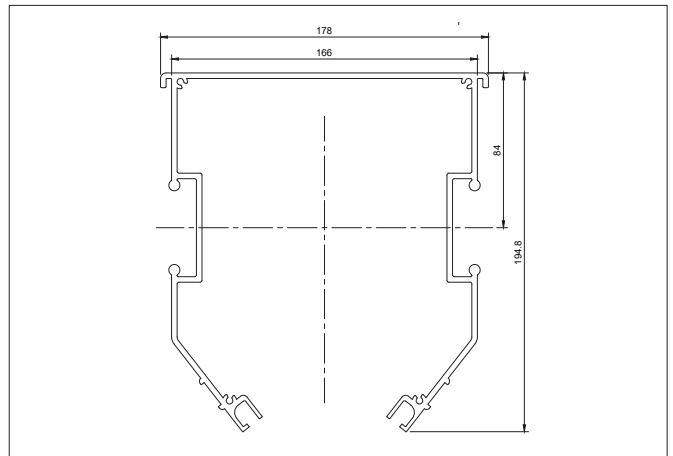

Kennlinie

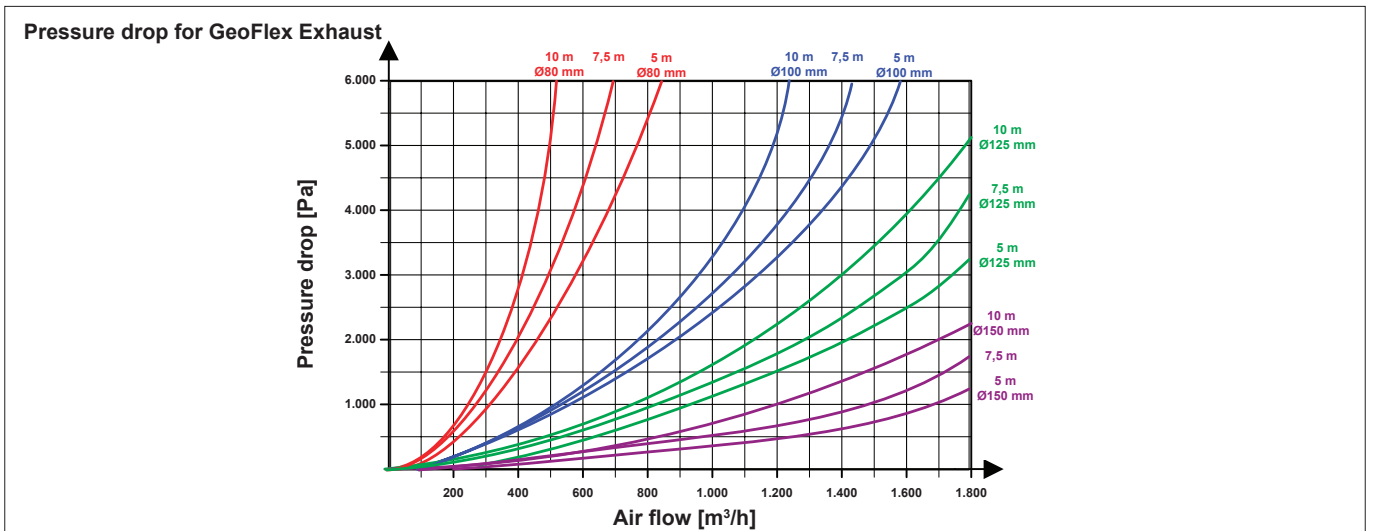
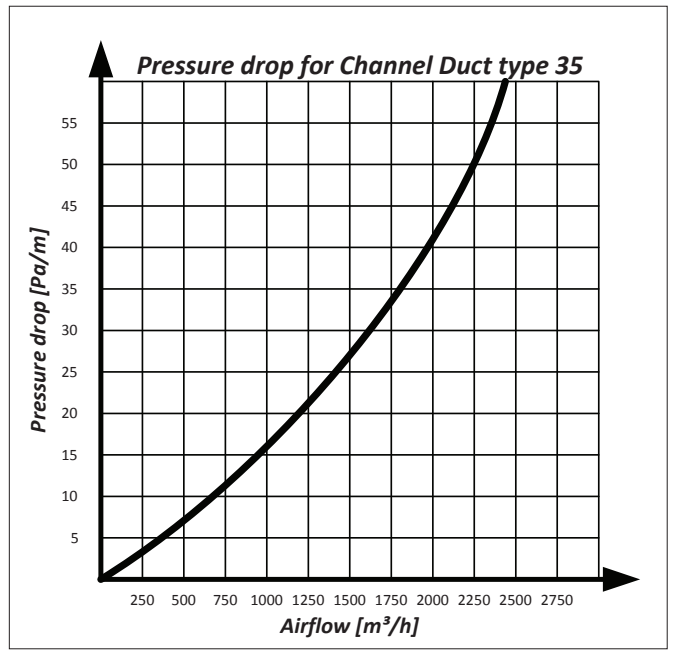
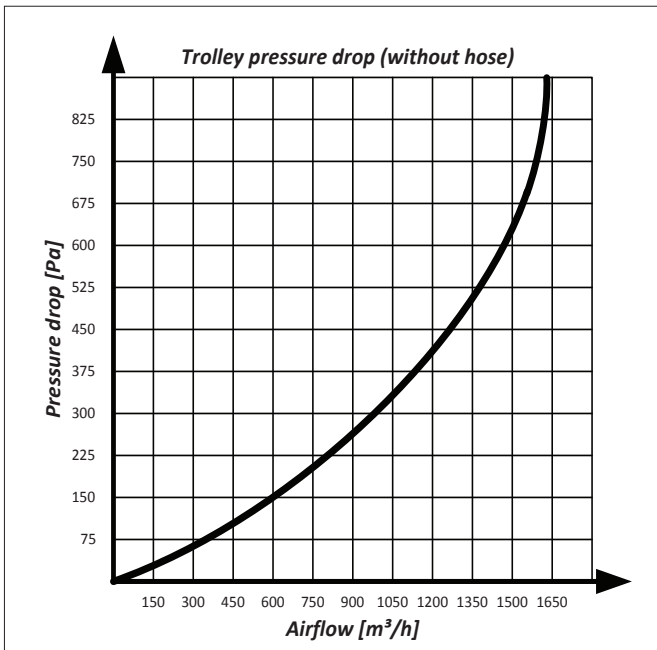

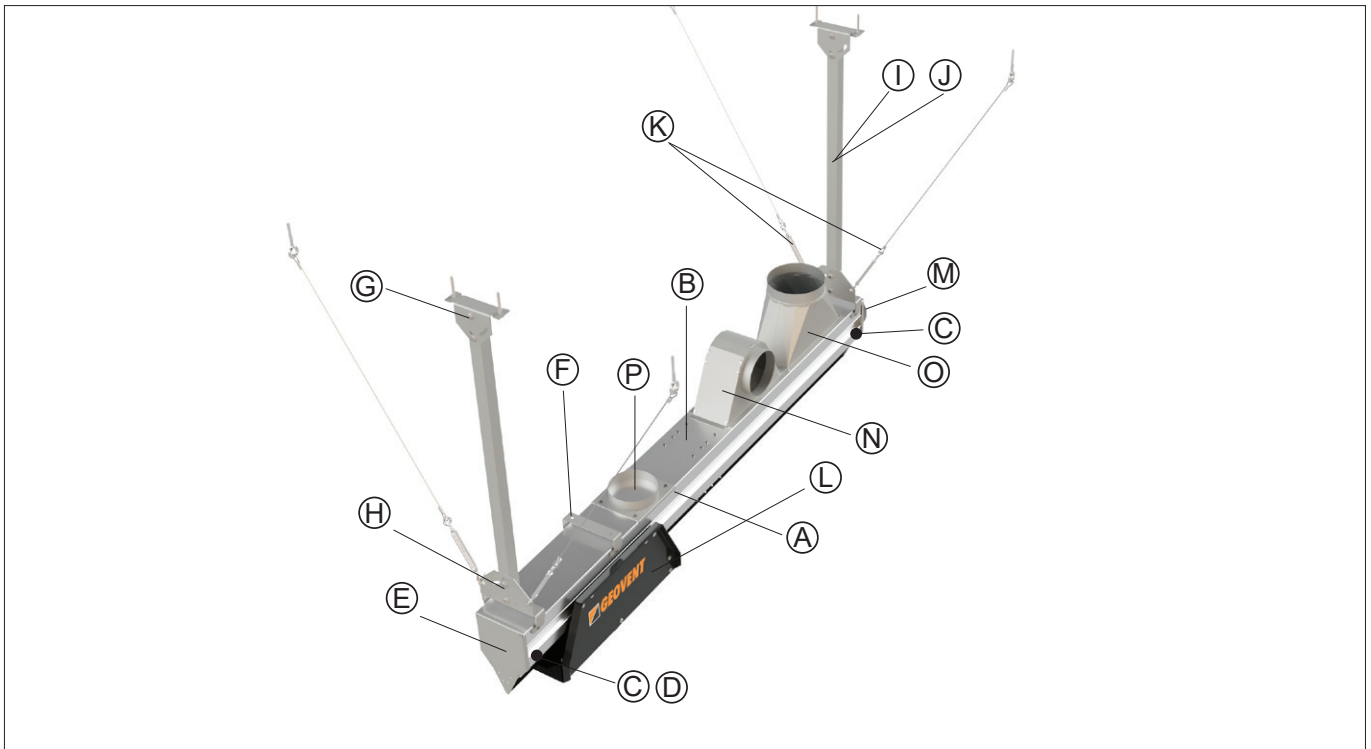

Ordering table for Channel duct

Pos.	Art. No.	Description
A:	07-307	Channel bracing for channel duct.
B:	07-330	Channel assembly bracket of for connecting 2 lengths of channel duct.
C:	07-477	End stop for trolley
D:	07-478	Spring end stop for trolley
E:	07-304	End cover
F+G+H+I/J+K	07-332	Suspension kit for 1m channel duct - Content: Suspension bracket, ceiling bracket, channel fittings, suspension profile and wiring kit 1 kit required for each point of fixation.
F+G+H+I/J+K	07-333	Suspension kit for 2m channel duct - Content: Suspension bracket, ceiling bracket, channel fittings, suspension profile and wiring kit 1 kit required for each point of fixation.
F:	07-301	Suspension bracket in galvanized steel
G:	07-302	Ceiling bracket with tilt function
H:	07-303	Channel fittings with tilt function for suspension profile
I:	07-315	Suspension profile 1 meter galvanized steel
J:	07-316	Suspension profile 2 meter galvanized steel
K:	07-317	Wiring kit
L:	07-322	Trolley type 35
M:	07-308	End connection $\varnothing 160$ mm, from the end of the channel duct to round channel
N:	07-309	Top outlet 90°, nipple $\varnothing 160$, from channel duct top to round channel
N:	07-310	Top outlet 90°, nipple $\varnothing 200$, from channel duct top to round channel
O:	07-311	Top outlet, nipple $\varnothing 160$ mm, from channel duct top to round channel
O:	07-312	Top outlet, nipple $\varnothing 200$ mm, from channel duct top to round channel
P:	07-314	Top outlet short, nipple $\varnothing 160$ mm, from channel duct top to round channel
P:	07-318	Top outlet short, nipple $\varnothing 200$ mm, from channel duct top to round channel